



EVENT SPACES

At Bank of America Winter Village



LODGE
BANSPLACE

Bank of America Winter Village at Bryant Park



Bank of America Winter Village at Bryant Park is Midtown Manhattan's winter wonderland. Celebrate the season with holiday shopping, rink-side dining, and outdoor ice skating. Open from late October through early March, Winter Village provides an unmatched setting to entertain in New York City during the winter season.

BRYANT PARK



OVERLOOK

Adjacent to the ice skating rink is Overlook, an event space that sits above the enchanting Winter Village landscape.

Overlook is perfect for holiday parties, receptions, corporate events, dinners, fund-raisers, weddings, media events, and more.

The space features sweeping views of the skating rink, Bryant Park, and Midtown Manhattan through its floor-to-ceiling glass walls and clear roof.

Enjoy custom menus created by our world-class caterers.

BRYANT PARK



OVERLOOK EVENT SPACE

- 2,300+ square foot* private event space with floor-to-ceiling windows overlooking the rink and Midtown Manhattan
- Approximately 225 guests for standing cocktail receptions
- Two monitors available for presentations and photos
- Full A/V system with preset lighting options
- Access to 17,000 sq. ft. outdoor ice skating rink; ice skating packages available at special rates
- Available from late October to early March
- Located in the heart of Midtown Manhattan, one block from Times Square and Grand Central Terminal, and close to all Midtown subways including the B, D, F, M, 1, 2, 3, 4, 5, 6, N, Q, R, W, and 7 lines

*Approximate square footage and subject to change.



BRYANT PARK

POLAR LOUNGE

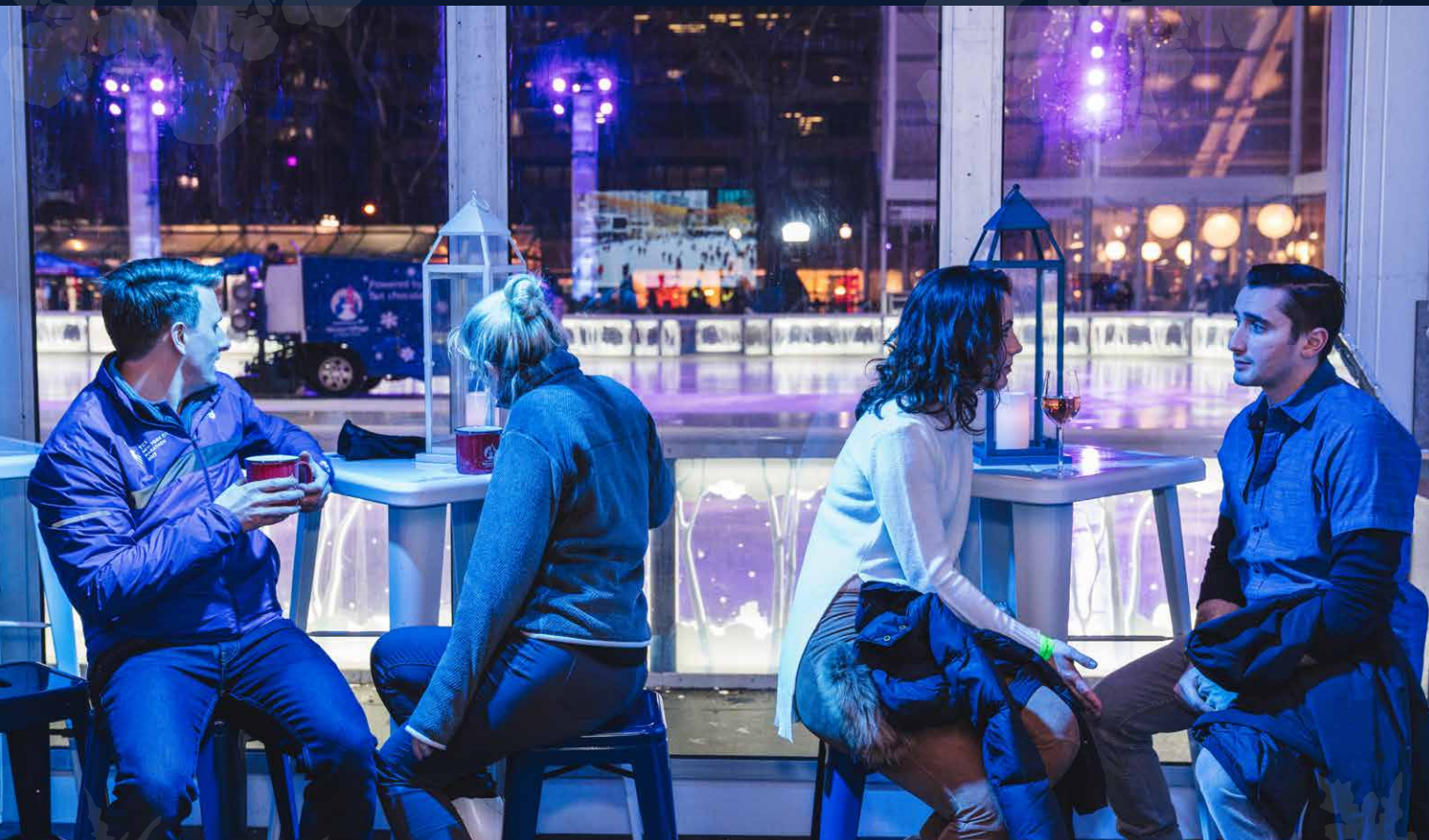

A cozy spot by the entrance onto The Rink, Polar Lounge can be booked in conjunction or separately from Overlook.

The 394 square foot space* fits up to 32 guests and is perfect for skating parties and more intimate gatherings. F&B options are available, making this place the ideal spot for guests to mingle when not on the ice.

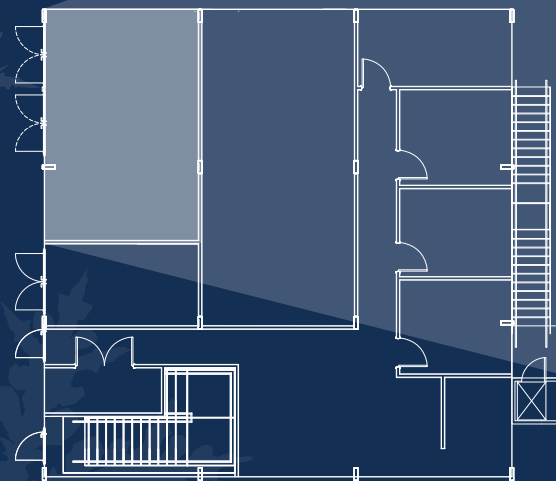

NORTH VIEW OF ICE RINK



BRYANT PARK

*Approximate square footage and subject to change.



GET IN TOUCH

For more information about hosting an event at **Overlook**, or **Polar Lounge**, please contact rink@bryantpark.org.

Please contact our preferred caterers for menu and layout options.

Union Square Events

Email: bpwv@unionsquareevents.com

Web: unionsquareevents.com

Abigail Kirsch

Jen Schepps, Director of Catering

jennifer.schepps@abigailkirsch.com

Web: abigailkirsch.com

Photos: Angelito Jusay,
Colin Miller, Kevin Ornelas
and Bryant Park Corporation